

Township No. 15 South Range No. 36 East Willamette Meridian, Oregon.

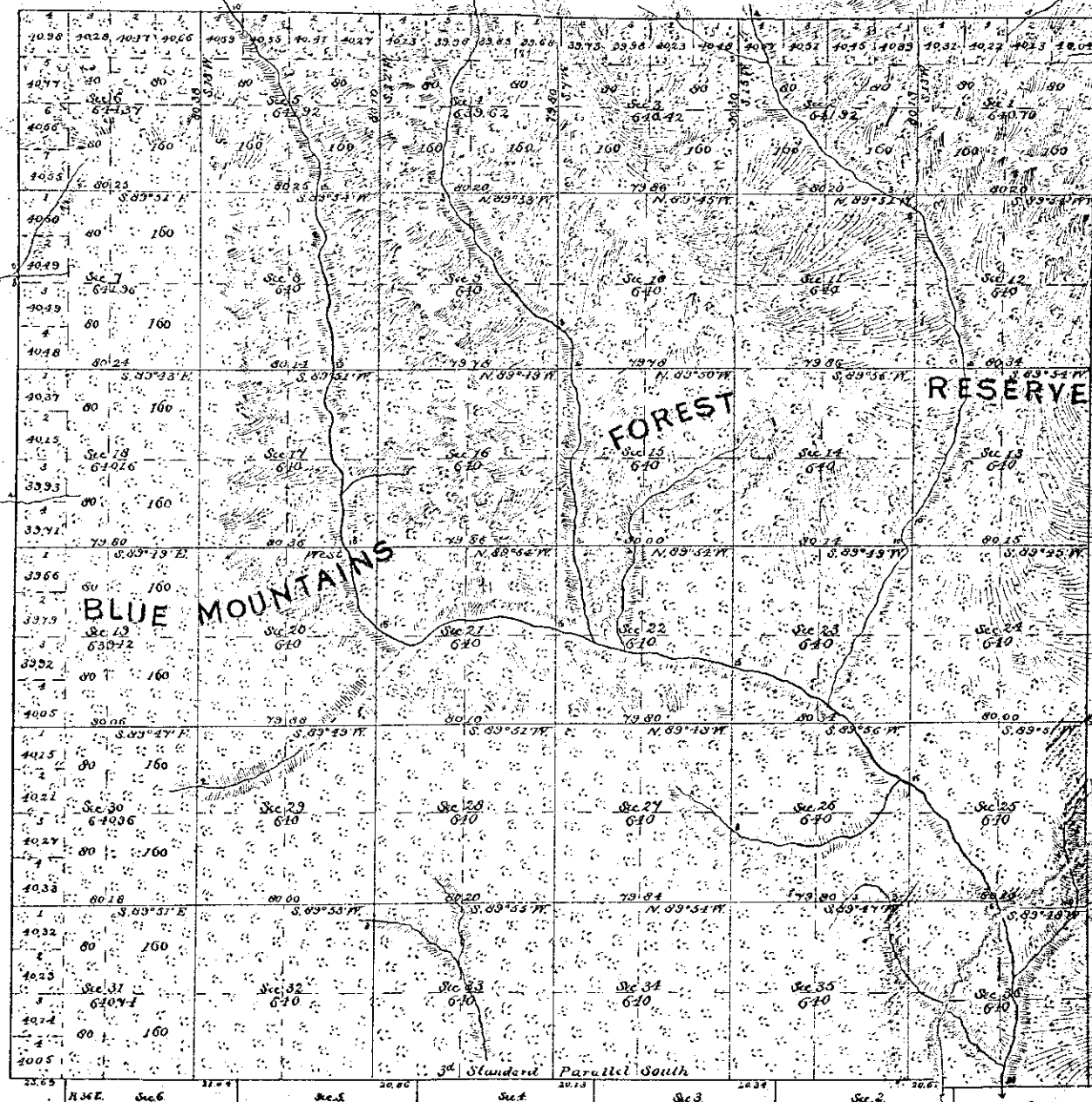

APPROVED BY THE HON. COMMISSIONER G. L. D. April 15 1882

SURVEYS DESIGNATED	BY WHOM SURVEYED	NO.	DATE OF CONTRACT	AMOUNT OF SURVEY	WHEN SURVEYED	MEAN DECLINATION
Township Lines	Eugene P. McKornack	330	July 2, 1881	6 00 47	Aug. 24 to Sept. 3d, 1881	70° 15' E.
Subdivisions	do do do	do do do do	do do do do	60 02 57		

Total number of Acres 3,052.13

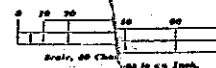

The above Map of the Subdivisions of Township No. 15 South of Range No. 36 East of the Willamette Meridian, Oregon, is strictly conformable to the Field Notes of the survey thereof on file in this Office, which have been examined and approved.
U. S. Surveyor-General's Office,
Portland, Oregon,
March 25, 1882. James C. Holman
Surveyor General of Oregon.